

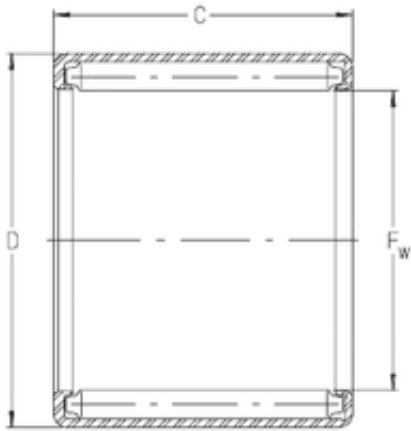

BEARING CORP.

71913C Angular Contact Ball Bearings 65x90x13cm

Bearing No. S88



S88 Bearing 2D drawings and 3D CAD models

Size	12.7x17.462x12.7 mm
Bore Diameter	12,7 mm
Outer Diameter	17,462 mm
Width	12,7 mm
Fw	12,7 mm
D	17,462 mm
C	12,7 mm
Weight	0,009 Kg
Basic dynamic load rating (C)	9,7 kN
Basic static load rating (C0)	16,3 kN